

SAMANA
OCEAN CREST



A SYMPHONY BY THE SEA

SAMANA

DEVELOPERS

WHERE PURPOSE SHAPES EVERY SPACE

SAMANA's legacy is rooted in a singular vision—to craft environments that elevate everyday life. Over three decades, we've transformed that vision into a portfolio of communities that stand as benchmarks of design, purpose, and aspiration.

From idea to execution, we pursue progress with intention and purpose, fusing innovation, aesthetic clarity, and community thinking into every development. The result is more than architecture. It's a curation of refined lifestyles that inspire, endure, and lead the way forward.

Where Complete Control
Meets Timeless Quality

SAMANA's end-to-end integration means no detail is outsourced, ensuring absolute control over timelines, costs, and uncompromised luxury.



DESIGN & PLANNING

Visionary concepts
engineered for reality.

ENGINEERING & CONSTRUCTION

Structural artistry meets
technical brilliance.

PROCUREMENT

Utilizing cutting-edge platforms
streamline sourcing and ensure
unmatched consistency.

QUALITY CONTROL

Precision-led systems that track,
review, and deliver quality.

CUSTOMER EXPERIENCE

End-to-end service with
precision and care.



FIVE ISLES OF WATERFRONT LUXURY

Set against the shimmering coastline of Dubai, Dubai Islands is an extraordinary waterfront destination that blends luxury, leisure, and lifestyle. This iconic master community offers pristine beaches, world-class hospitality, vibrant retail experiences, and exceptional connectivity — creating a destination where every moment feels like a getaway.

DUBAI ISLANDS

5

Interconnected
Islands

86+

Resorts &
Hotels

21KMS

Spread-out
Beaches



Golf Courses



Shopping Malls



Healthcare Facilities



SAMANA OCEAN CREST





SAMANA
OCEAN CREST

A SYMPHONY BY THE SEA





SAMANA Ocean Crest welcomes you to a sanctuary where sea breezes soothe the spirit and immaculate design revives the soul. Tucked within the iconic Dubai Islands, this exclusive retreat brings the rhythm of the ocean to your doorstep. From curated interiors to panoramic views, every space whispers refinement—and every day feels like an escape.

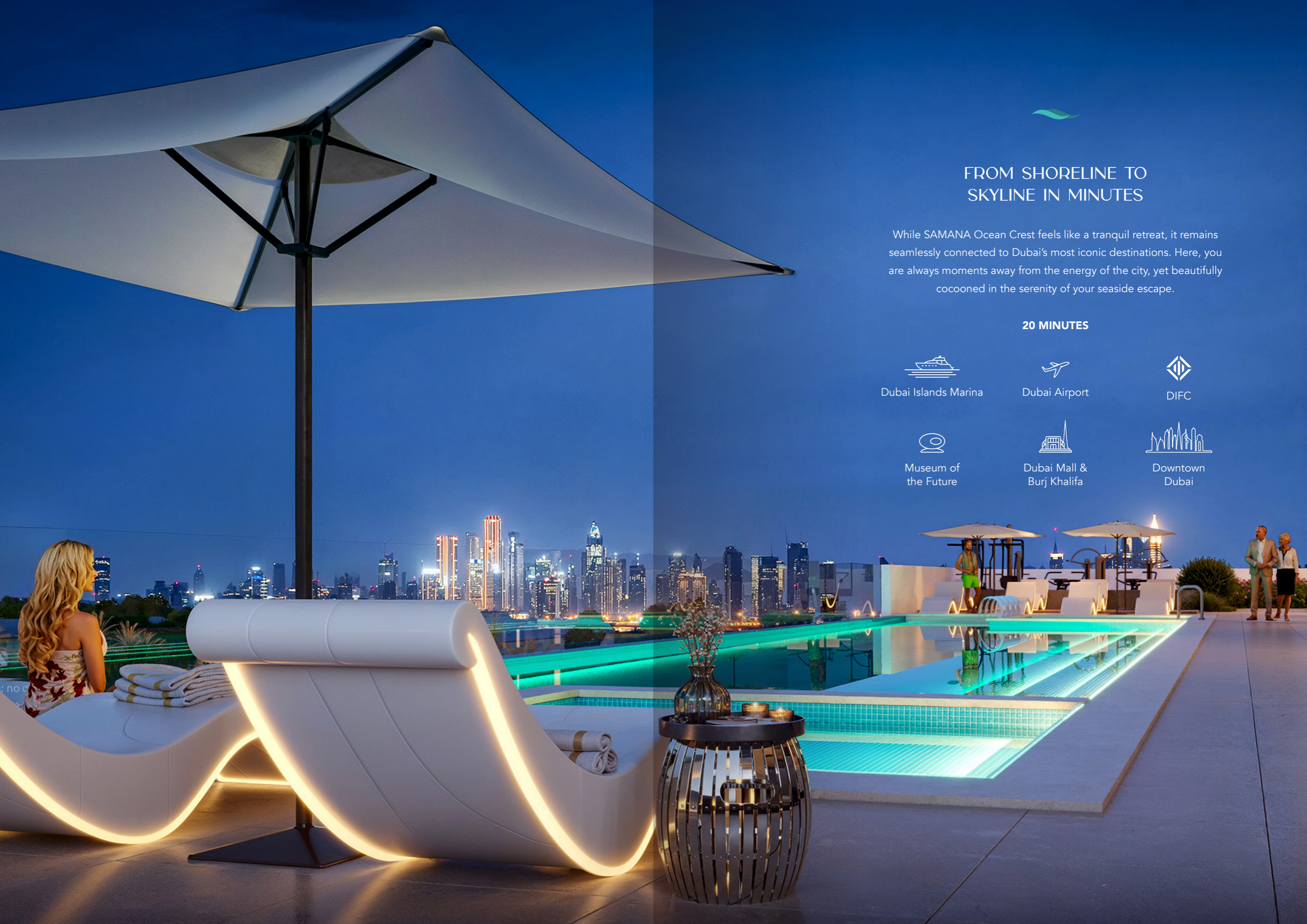

FROM SHORELINE TO SKYLINE IN MINUTES

While SAMANA Ocean Crest feels like a tranquil retreat, it remains seamlessly connected to Dubai's most iconic destinations. Here, you are always moments away from the energy of the city, yet beautifully cocooned in the serenity of your seaside escape.

20 MINUTES



Dubai Islands Marina



Dubai Airport



DIFC



Museum of the Future



Dubai Mall & Burj Khalifa



Downtown Dubai



WHERE THE SEA LEADS YOU HOME

SAMANA Ocean Crest is a serene expression of waterfront living. This coastal address blends architectural grace with breathtaking surroundings — where every view opens to the calm of the Arabian Gulf and every breeze carries the spirit of retreat. This location is not just picturesque; it is purposeful, private, prestigious, and offers a sense of poetic escape.





A SILHOUETTE INSPIRED BY THE SEA

Inspired by the gentle movement of the sea and sculpted with intention, SAMANA Ocean Crest presents a bold yet graceful architectural identity. Clean lines and layered textures come together in a composition that reflects its coastal surroundings. With only 56 residences, SAMANA Ocean Crest offers a rare sense of privacy in an emerging island destination, where contemporary design rises in harmony with the horizon.



ELEGANCE IN EVERY DETAIL

Here, luxury is expressed in the quietest of ways—through soft textures, intelligent layouts, and finishes chosen not just for their elegance, but for how they make you feel. This is not just a home, but an experience crafted for those who appreciate grace in the details and calm in the everyday.









A LIFESTYLE CURATED AROUND YOU

At SAMANA Ocean Crest, amenities are more than just conveniences. Every space is designed to promote balance and connection, offering moments of movement and stillness, energy and ease.

IMMERSED IN LEISURE

Leisure water lounge

Children's splash pad

Infinity Pool

Kids' Pool

Jacuzzi

Outdoor Shower

WELLNESS IN MOTION

Kids' Play Area

Outdoor Gym

Indoor Gym

Jogging Track

RETREAT INTO CALM

Steam

Sauna

SOCIAL CORNERS

BBQ

Sun deck

Shaded seating









SPACES SHAPED BY LIGHT AND FLOW

Carefully curated to reflect the elegance of coastal living, each residence offers a refined sense of space and functionality. Intelligent layouts, clean design language, and fluid transitions between living areas create an atmosphere that feels calm, spacious, and beautifully connected.



COMMUNITY

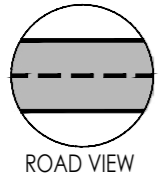

ROAD VIEW

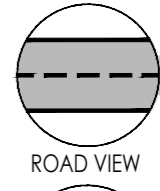

ROAD VIEW



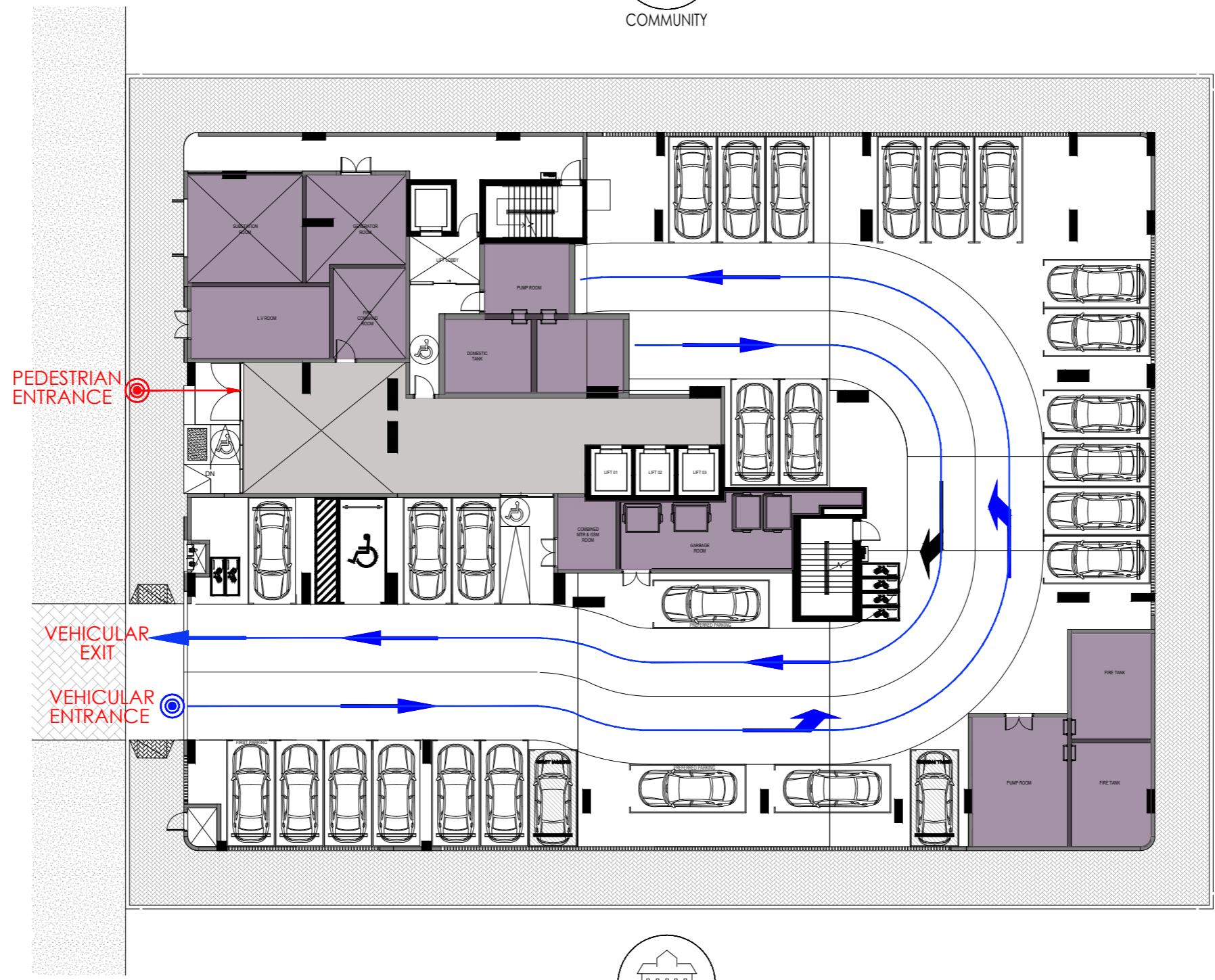

COMMUNITY



COMMUNITY



LEGEND:

-  ENTRANCE LOBBY
-  SERVICES

FLOOR PLAN

GROUND FLOOR PLAN

Disclaimer:

1. All Areas have been provided by our consultant architects.
2. Actual suite area may vary from the stated area. Drawings not to scale. The developer reserves the right to make revisions.
3. Calculation of suite area is measured as the area bounded by the centre line of demising or partition walls separating one unit from another unit, the exterior face of all exterior walls, and the exterior face of the corridor wall enclosing the adjoining unit.
4. Calculation of balcony area is measured as the area bounded by the centre line of demising or partition walls separating one unit from another unit, the outmost face of the enclosing guard and the external face of the adjoining balcony.
5. The units are measured at typical floor in the building. Columns may vary in size depending on the floor level.
6. For each unit type, unit sizes and details might be slightly different. Please refer to the sales and purchase agreement for the actual size of each specific unit.
7. North direction as per key plan.



COMMUNITY



Sea Facing



Sea Facing

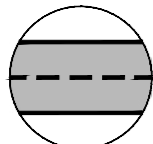

ROAD VIEW

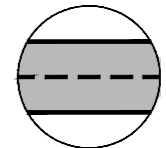

ROAD VIEW



COMMUNITY



N

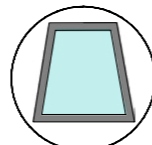
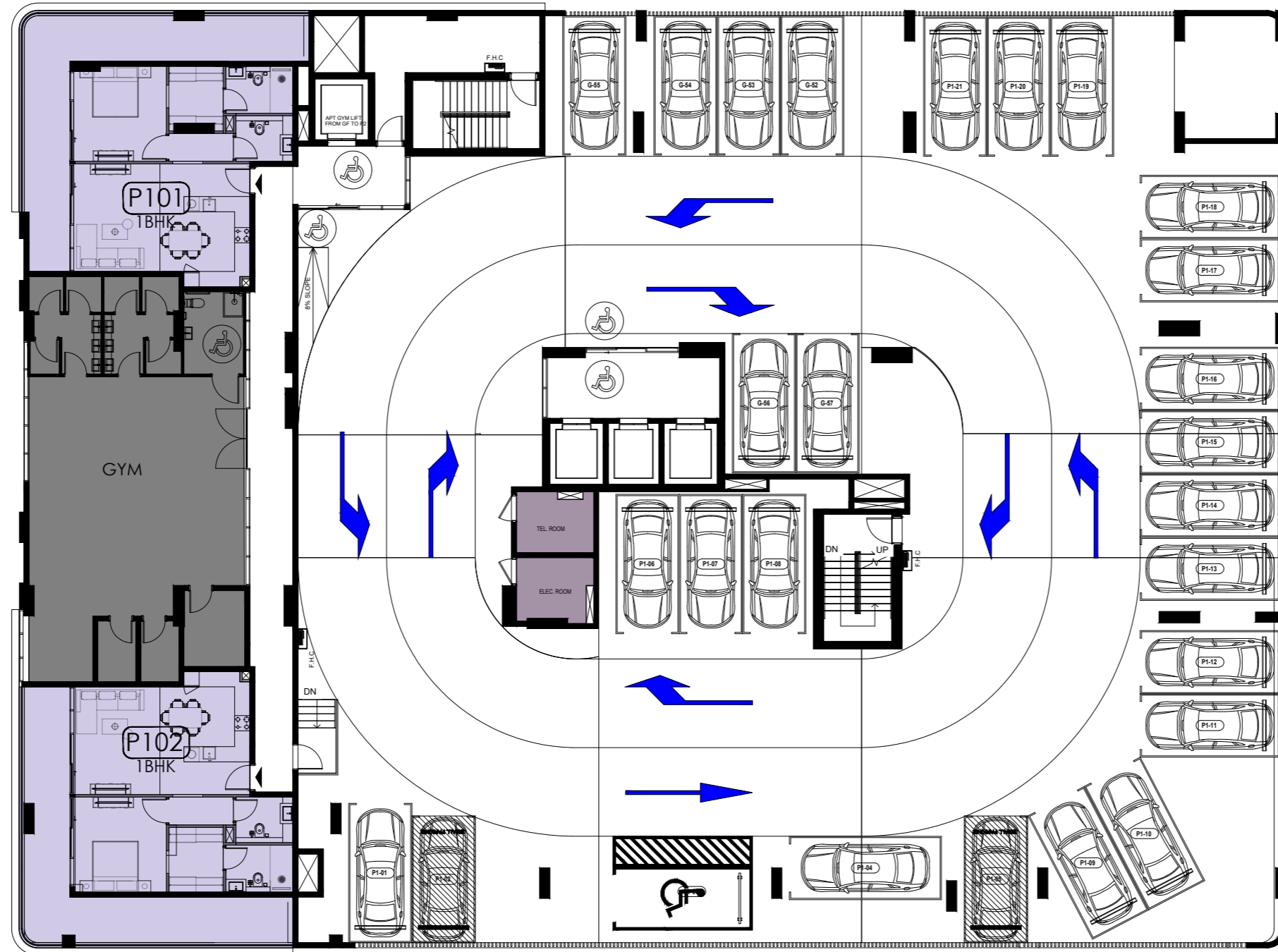

POOL VIEW



COMMUNITY

OCEAN CREST BY SD		
PODIUM - 01 PLAN		
Units	Units/ Floor	Total Nos
1 BEDROOM	2	2
TOTAL UNITS	2	2

FLOOR PLAN

PODIUM 01 PLAN

Disclaimer:

1. All Areas have been provided by our consultant architects.
2. Actual suite area may vary from the stated area. Drawings not to scale. The developer reserves the right to make revisions.
3. Calculation of suite area is measured as the area bounded by the centre line of demising or partition walls separating one unit from another unit, the exterior face of all exterior walls, and the exterior face of the corridor wall enclosing the adjoining unit.
4. Calculation of balcony area is measured as the area bounded by the centre line of demising or partition walls separating one unit from another unit, the outmost face of the enclosing guard and the external face of the adjoining balcony.
5. The units are measured at typical floor in the building. Columns may vary in size depending on the floor level.
6. For each unit type, unit sizes and details might be slightly different. Please refer to the sales and purchase agreement for the actual size of each specific unit.
7. North direction as per key plan.

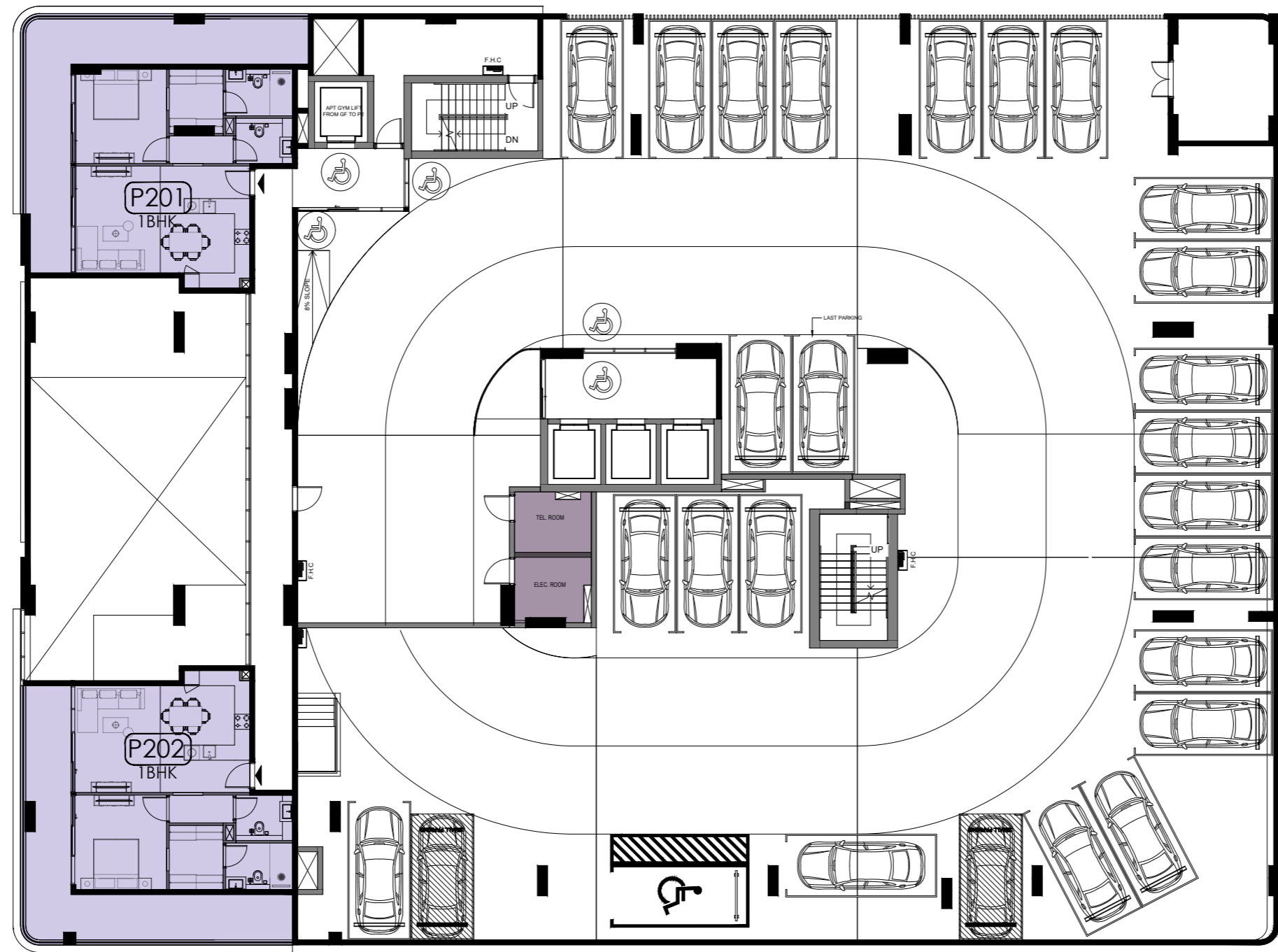
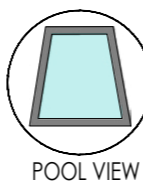
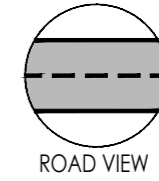
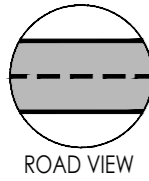

FLOOR PLAN
PODIUM 02 PLAN

OCEAN CREST BY SD		
PODIUM - 02 PLAN		
Units	Units/ Floor	Total Nos
1 BEDROOM	2	2
TOTAL UNITS	2	2

Disclaimer:
 1. All Areas have been provided by our consultant architects.
 2. Actual suite area may vary from the stated area. Drawings not to scale. The developer reserves the right to make revisions.
 3. Calculation of suite area is measured as the area bounded by the centre line of demising or partition walls separating one unit from another unit, the exterior face of all exterior walls, and the exterior face of the corridor wall enclosing the adjoining unit.
 4. Calculation of balcony area is measured as the area bounded by the centre line of demising or partition walls separating one unit from another unit, the outmost face of the enclosing guard and the external face of the adjoining balcony.
 5. The units are measured at typical floor in the building. Columns may vary in size depending on the floor level.
 6. For each unit type, unit sizes and details might be slightly different. Please refer to the sales and purchase agreement for the actual size of each specific unit.
 7. North direction as per key plan.



COMMUNITY



Sea Facing



Sea Facing

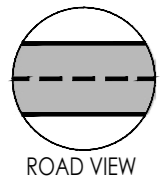

ROAD VIEW

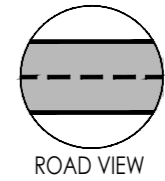

ROAD VIEW



COMMUNITY

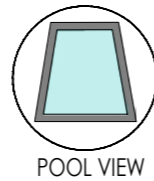

POOL VIEW



COMMUNITY

OCEAN CREST BY SD		
1ST FLOOR PLAN		
Units	Units/ Floor	Total Nos
1 BEDROOM + POOL	4	4
2 BEDROOM + STORE + POOL	4	4
TOTAL UNITS	8	8

FLOOR PLAN

1st FLOOR PLAN

Disclaimer:
 1. All Areas have been provided by our consultant architects.
 2. Actual suite area may vary from the stated area. Drawings not to scale. The developer reserves the right to make revisions.
 3. Calculation of suite area is measured as the area bounded by the centre line of demising or partition walls separating one unit from another unit, the exterior face of all exterior walls, and the exterior face of the corridor wall enclosing the adjoining unit.
 4. Calculation of balcony area is measured as the area bounded by the centre line of demising or partition walls separating one unit from another unit, the outmost face of the enclosing guard and the external face of the adjoining balcony.
 5. The units are measured at typical floor in the building. Columns may vary in size depending on the floor level.
 6. For each unit type, unit sizes and details might be slightly different. Please refer to the sales and purchase agreement for the actual size of each specific unit.
 7. North direction as per key plan.



COMMUNITY

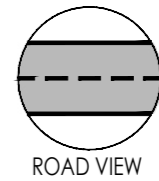

ROAD VIEW



COMMUNITY

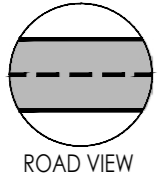

ROAD VIEW

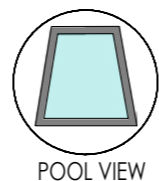

POOL VIEW



COMMUNITY



OCEAN CREST BY SD		
TYPICAL FLOOR PLAN (2ND TO 4TH)		
Units	Units/ Floor	Total Nos
1 BEDROOM + POOL	2	6
2 BEDROOM + POOL	1	3
2 BEDROOM + STORE + POOL	5	15
TOTAL UNITS	8	24

FLOOR PLAN

TYPICAL FLOOR PLAN (2ND TO 4TH)

Disclaimer:
 1. All Areas have been provided by our consultant architects.
 2. Actual suite area may vary from the stated area. Drawings not to scale. The developer reserves the right to make revisions.
 3. Calculation of suite area is measured as the area bounded by the centre line of demising or partition walls separating one unit from another unit, the exterior face of all exterior walls, and the exterior face of the corridor wall enclosing the adjoining unit.
 4. Calculation of balcony area is measured as the area bounded by the centre line of demising or partition walls separating one unit from another unit, the outmost face of the enclosing guard and the external face of the adjoining balcony.
 5. The units are measured at typical floor in the building. Columns may vary in size depending on the floor level.
 6. For each unit type, unit sizes and details might be slightly different. Please refer to the sales and purchase agreement for the actual size of each specific unit.
 7. North direction as per key plan.

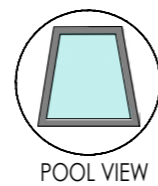
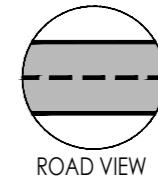
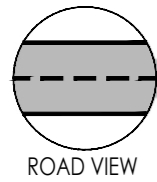

OCEAN CREST BY SD		
TYPICAL FLOOR PLAN (5TH & 6TH)		
Units	Units/ Floor	Total Nos
2 BEDROOM + POOL	1	2
2 BEDROOM + STORE + POOL	5	10
3 BEDROOM + LAUNDRY + STORE + POOL	1	2
TOTAL UNITS	7	14

FLOOR PLAN

TYPICAL FLOOR PLAN (5TH & 6TH)

Disclaimer:
 1. All Areas have been provided by our consultant architects.
 2. Actual suite area may vary from the stated area. Drawings not to scale. The developer reserves the right to make revisions.
 3. Calculation of suite area is measured as the area bounded by the centre line of demising or partition walls separating one unit from another unit, the exterior face of all exterior walls, and the exterior face of the corridor wall enclosing the adjoining unit.
 4. Calculation of balcony area is measured as the area bounded by the centre line of demising or partition walls separating one unit from another unit, the outmost face of the enclosing guard and the external face of the adjoining balcony.
 5. The units are measured at typical floor in the building. Columns may vary in size depending on the floor level.
 6. For each unit type, unit sizes and details might be slightly different. Please refer to the sales and purchase agreement for the actual size of each specific unit.
 7. North direction as per key plan.



Sea Facing



Sea Facing



COMMUNITY

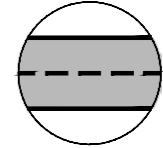

ROAD VIEW



COMMUNITY

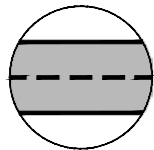

ROAD VIEW

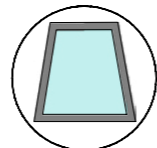

POOL VIEW



COMMUNITY



OCEAN CREST BY SD		
1ST FLOOR PLAN		
Units	Units/ Floor	Total Nos
1 BEDROOM + POOL	1	1
2 BEDROOM + STORE + POOL	5	5
3 BEDROOM + LAUNDRY + POOL	1	1
TOTAL UNITS	7	7

FLOOR PLAN

7th FLOOR PLAN

Disclaimer:
 1. All Areas have been provided by our consultant architects.
 2. Actual suite area may vary from the stated area. Drawings not to scale. The developer reserves the right to make revisions.
 3. Calculation of suite area is measured as the area bounded by the centre line of demising or partition walls separating one unit from another unit, the exterior face of all exterior walls, and the exterior face of the corridor wall enclosing the adjoining unit.
 4. Calculation of balcony area is measured as the area bounded by the centre line of demising or partition walls separating one unit from another unit, the outmost face of the enclosing guard and the external face of the adjoining balcony.
 5. The units are measured at typical floor in the building. Columns may vary in size depending on the floor level.
 6. For each unit type, unit sizes and details might be slightly different. Please refer to the sales and purchase agreement for the actual size of each specific unit.
 7. North direction as per key plan.



COMMUNITY

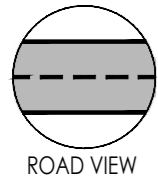

ROAD VIEW

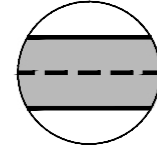

ROAD VIEW



COMMUNITY

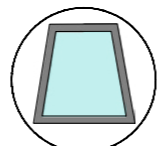

POOL VIEW



COMMUNITY



OCEAN CREST BY SD		
1ST FLOOR PLAN		
Units	Units/ Floor	Total Nos
1 BEDROOM + POOL	1	1
2 BEDROOM + STORE + POOL	3	3
3 BEDROOM + LAUNDRY + POOL	1	1
4 BEDROOM + MAID + POOL	1	1
TOTAL UNITS	6	6

FLOOR PLAN

8th FLOOR PLAN

Disclaimer:
 1. All Areas have been provided by our consultant architects.
 2. Actual suite area may vary from the stated area. Drawings not to scale. The developer reserves the right to make revisions.
 3. Calculation of suite area is measured as the area bounded by the centre line of demising or partition walls separating one unit from another unit, the exterior face of all exterior walls, and the exterior face of the corridor wall enclosing the adjoining unit.
 4. Calculation of balcony area is measured as the area bounded by the centre line of demising or partition walls separating one unit from another unit, the outmost face of the enclosing guard and the external face of the adjoining balcony.
 5. The units are measured at typical floor in the building. Columns may vary in size depending on the floor level.
 6. For each unit type, unit sizes and details might be slightly different. Please refer to the sales and purchase agreement for the actual size of each specific unit.
 7. North direction as per key plan.

SAMANA

DEVELOPERS



1 BEDROOM



PODIUM 1ST FLOOR KEYPLAN
UNIT - P101, P102



PODIUM 2ND FLOOR KEYPLAN
UNIT - P201, P202

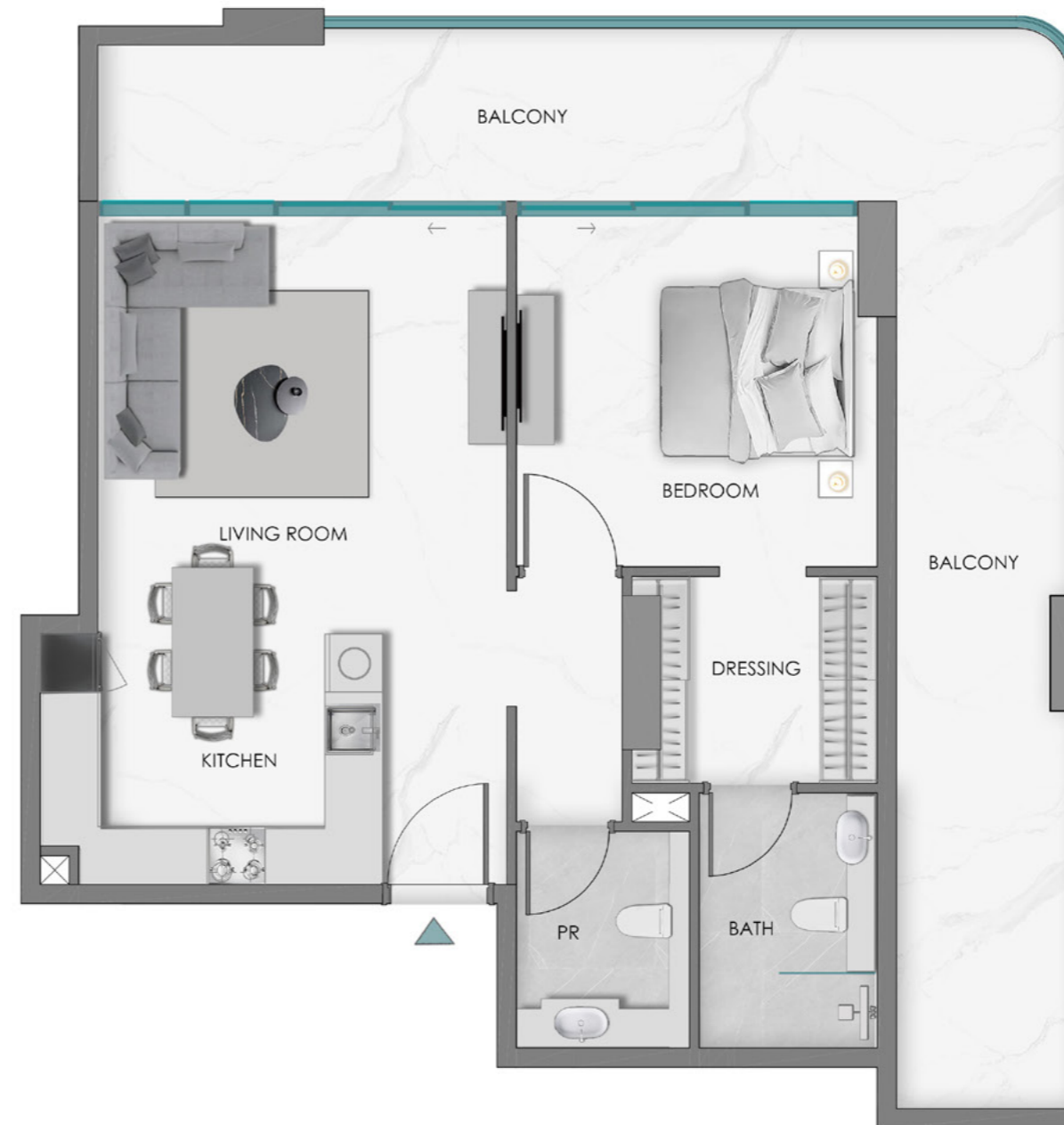

Disclaimer:
1. All room dimensions are measured to structural elements and exclude wall finishes and construction tolerances.
2. All dimensions have been provided by our consultant architects.
3. All materials, dimensions and drawings are approximate. Information is subject to change without notice.
4. Actual suite area may vary from the stated area. Drawings not to scale. The developer reserves the right to make revisions.
5. For each unit type, unit sizes and details might be slightly different. Please refer to the sales and purchase agreement for the actual size of each specific unit.
6. North direction as per the Keyplan

SAMANA

DEVELOPERS



1 BEDROOM + POOL

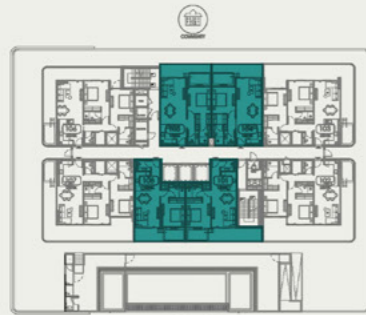

1ST FLOOR KEYPLAN
UNIT - 101, 104, 105, 108



2ND - 4TH TYPICAL FLOOR KEYPLAN
UNIT - 201, 208, 301, 308, 401, 408,



7TH FLOOR KEYPLAN
UNIT - 704



8TH FLOOR KEYPLAN
UNIT - 803



Disclaimer:
 1. All room dimensions are measured to structural elements and exclude wall finishes and construction tolerances.
 2. All dimensions have been provided by our consultant architects.
 3. All materials, dimensions and drawings are approximate. Information is subject to change without notice.
 4. Actual suite area may vary from the stated area. Drawings not to scale. The developer reserves the right to make revisions.
 5. For each unit type, unit sizes and details might be slightly different. Please refer to the sales and purchase agreement for the actual size of each specific unit.
 6. North direction as per the Keyplan



2 BEDROOM + POOL (TYPE 1)

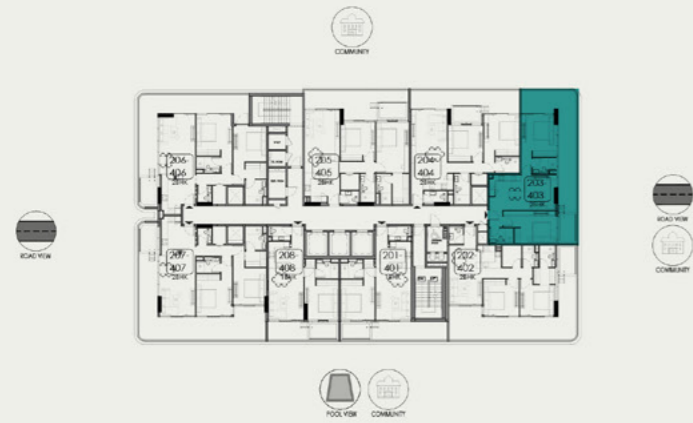

2ND TO 4TH TYPICAL FLOOR KEYPLAN

UNIT - 203, 303, 403



5TH & 6TH TYPICAL FLOOR KEYPLAN

UNIT - 503, 603

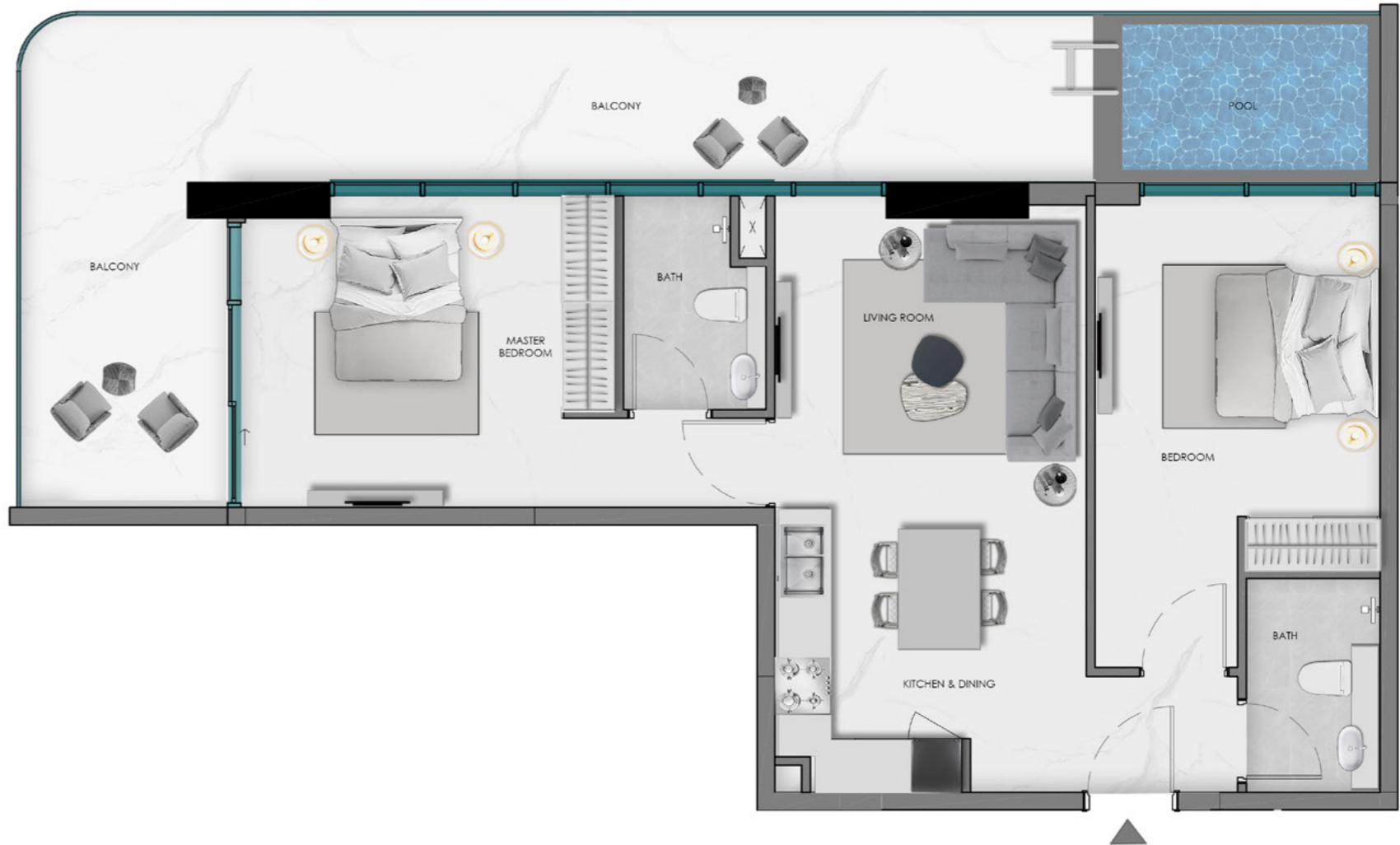

Disclaimer:
 1. All room dimensions are measured to structural elements and exclude wall finishes and construction tolerances.
 2. All dimensions have been provided by our consultant architects.
 3. All materials, dimensions and drawings are approximate. Information is subject to change without notice.
 4. Actual suite area may vary from the stated area. Drawings not to scale. The developer reserves the right to make revisions.
 5. For each unit type, unit sizes and details might be slightly different. Please refer to the sales and purchase agreement for the actual size of each specific unit.
 6. North direction as per the Keyplan

SAMANA

DEVELOPERS

2 BEDROOM + STORE + POOL (TYPE 2)

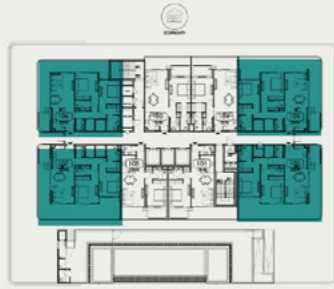

1ST FLOOR KEYPLAN
UNIT - 102, 103, 106, 107



2ND TO 4TH TYPICAL FLOOR KEYPLAN
UNIT - 202, 204, 205, 206, 207, 302, 304, 305, 306, 307, 402, 404,
405, 406, 407



5TH & 6TH TYPICAL FLOOR KEYPLAN
UNIT - 501, 502, 504, 505, 506, 601, 602, 604, 605, 606



7TH FLOOR KEYPLAN
UNIT - 701, 702, 703, 705, 706



8TH FLOOR KEYPLAN
UNIT - 801, 804, 805

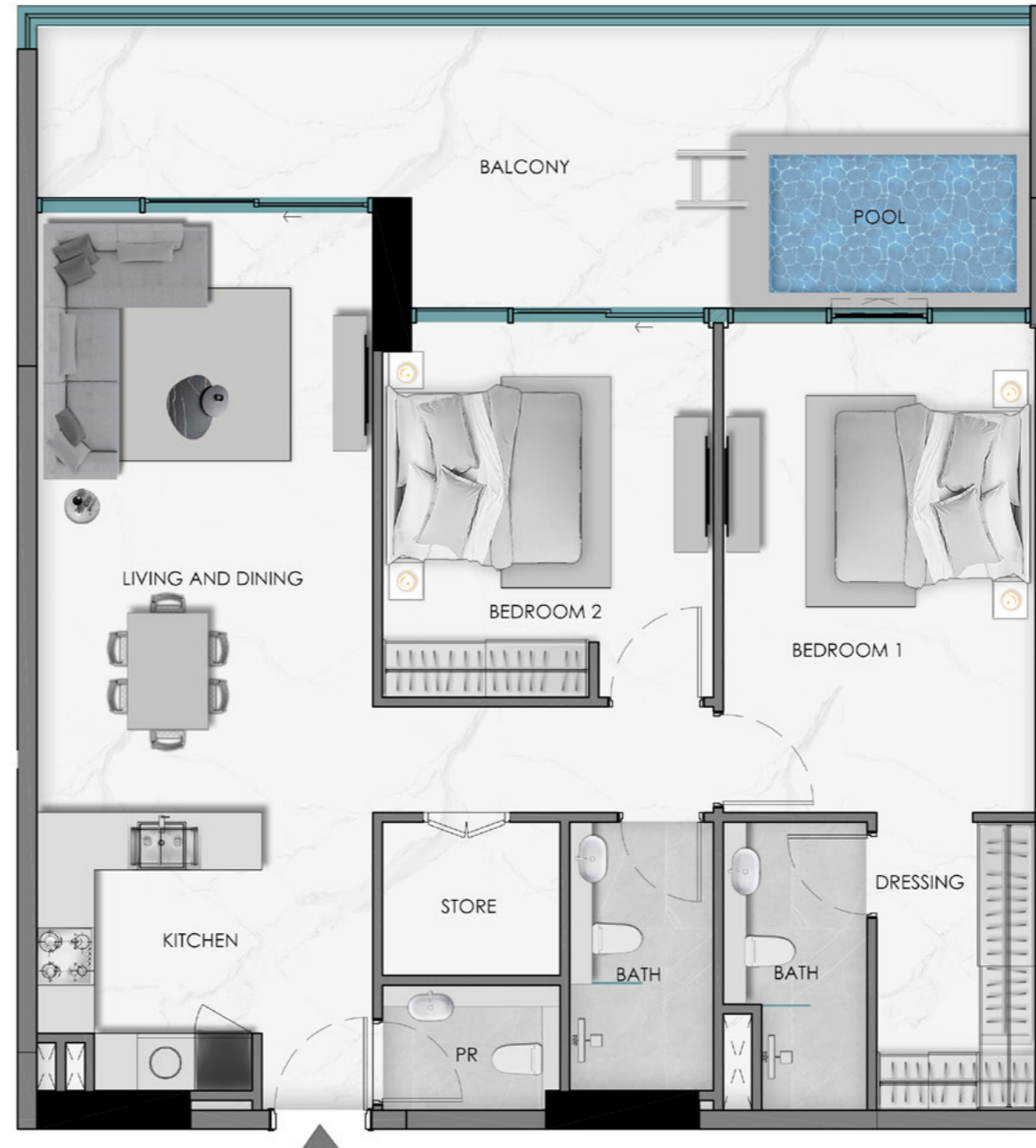

Disclaimer:
 1. All room dimensions are measured to structural elements and exclude wall finishes and construction tolerances.
 2. All dimensions have been provided by our consultant architects.
 3. All materials, dimensions and drawings are approximate. Information is subject to change without notice.
 4. Actual suite area may vary from the stated area. Drawings not to scale. The developer reserves the right to make revisions.
 5. For each unit type, unit sizes and details might be slightly different. Please refer to the sales and purchase agreement for the actual size of each specific unit.
 6. North direction as per the Keyplan

SAMANA

DEVELOPERS

3 BEDROOM + LAUNDRY + POOL (TYPE 1)



7TH FLOOR KEYPLAN
UNIT - 707



8TH FLOOR KEYPLAN
UNIT - 806



Disclaimer:
 1. All room dimensions are measured to structural elements and exclude wall finishes and construction tolerances.
 2. All dimensions have been provided by our consultant architects.
 3. All materials, dimensions and drawings are approximate. Information is subject to change without notice.
 4. Actual suite area may vary from the stated area. Drawings not to scale. The developer reserves the right to make revisions.
 5. For each unit type, unit sizes and details might be slightly different. Please refer to the sales and purchase agreement for the actual size of each specific unit.
 6. North direction as per the Keyplan

SAMANA

DEVELOPERS



3 BEDROOM + LAUNDRY + STORE + POOL (TYPE 2)



5TH & 6TH TYPICAL FLOOR KEYPLAN
UNIT - 507, 607



Disclaimer:
1. All room dimensions are measured to structural elements and exclude wall finishes and construction tolerances.
2. All dimensions have been provided by our consultant architects.
3. All materials, dimensions and drawings are approximate. Information is subject to change without notice.
4. Actual suite area may vary from the stated area. Drawings not to scale. The developer reserves the right to make revisions.
5. For each unit type, unit sizes and details might be slightly different. Please refer to the sales and purchase agreement for the actual size of each specific unit.
6. North direction as per the Keyplan

SAMANA

DEVELOPERS



4 BEDROOM + MAID + POOL

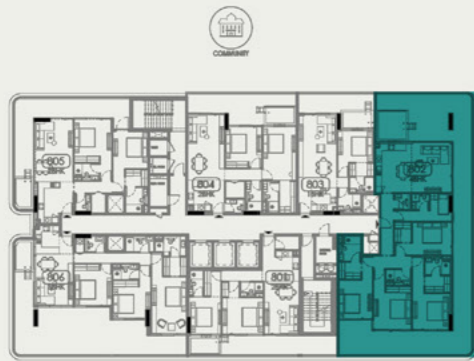

8TH FLOOR KEYPLAN
UNIT - 802



Disclaimer:
1. All room dimensions are measured to structural elements and exclude wall finishes and construction tolerances.
2. All dimensions have been provided by our consultant architects.
3. All materials, dimensions and drawings are approximate. Information is subject to change without notice.
4. Actual suite area may vary from the stated area. Drawings not to scale. The developer reserves the right to make revisions.
5. For each unit type, unit sizes and details might be slightly different. Please refer to the sales and purchase agreement for the actual size of each specific unit.
6. North direction as per the Keyplan

SAMANA
OCEAN CREST

SAMANA

DEVELOPERS